

EXISTING DWELLING:	753 sf / 68,28 sq.m.
EXISTING DWELLING DECK 1:	416 sf / 38,64 sq.m.
EXISTING DWELLING DECK 2:	147 sf / 13,65 sq.m.
EXISTING PORCH:	36 sf / 3,34 sq.m.

**EXISTING LOT COVERAGE:** 1352 sf / 125.60 sq.m.  
 \*\*\* DOCKS NOT INCLUDED IN LOT COVERAGE \*\*\*  
 = 7.07 %

EXISTING DWELLING:	753 sqft / 68.28 sq.m.
MAIN FLOOR ADDITION:	124 sqft
PROPOSED PORCH:	40 sqft
PROPOSED OPEN DECK:	490 sqft

**EXISTING LOT COVERAGE:** 1407 sqft  
 \*\*\* DOCKS NOT INCLUDED IN LOT COVERAGE \*\*\* = 7.37 %

 EXISTING DECKS TO BE REMOVED PROPOSED DWELLING ADDITION  
AND PROPOSED DECK

**Legal property address: 3213 Ahmic Lake Road, Magnetawan**

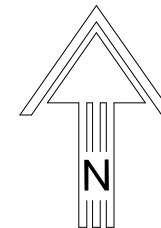
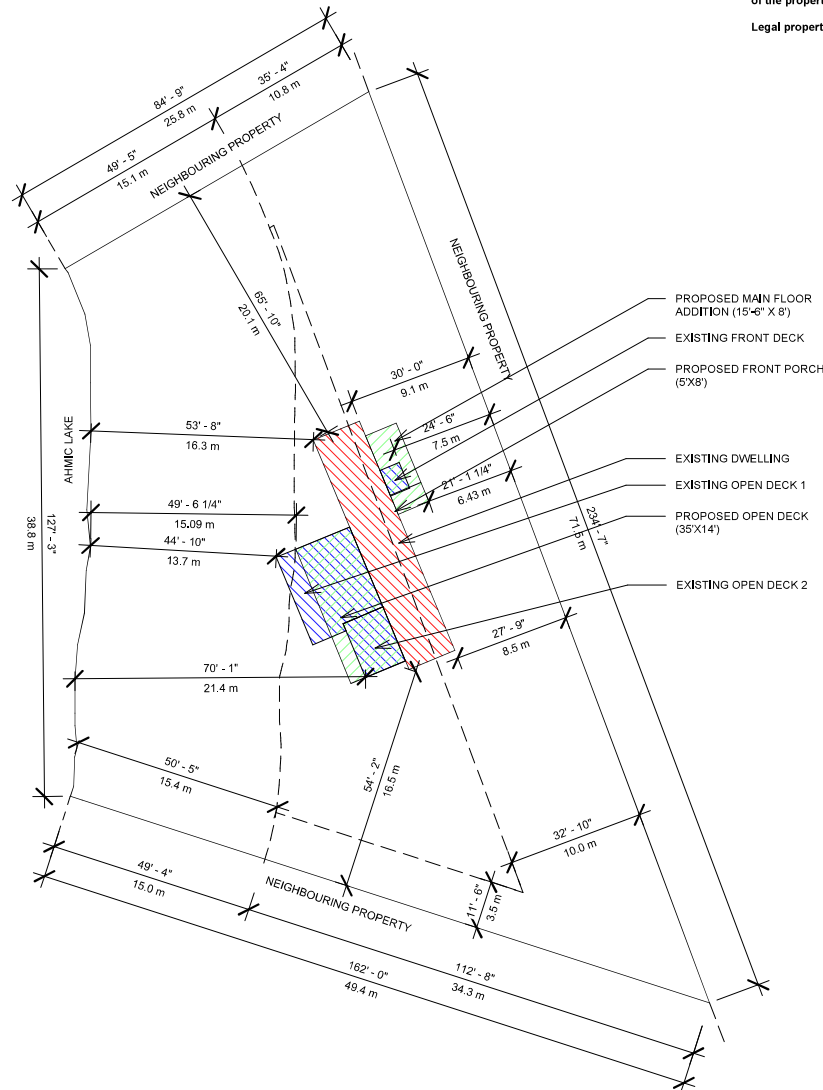
[illegible]

Liscombe Construction -  
Duck House Raise

## Site Plan

3213 Ahmic Lake Rd, Magnetawan

Date	2025-06-17
------	------------

Contractor	Liscombe Construction
Owner	Garry Duck
Drafted by	Nathan Geddes
Designer Review	Victoria Hoffmann
Designer BCIN	47 130
Company BCIN	104360

S001	Scale	As indicated
------	-------	--------------