

**THE CORPORATION OF THE MUNICIPALITY OF MAGNETAWAN**  
**BY-LAW NO. 2013-19**

Being a By-law to amend By-law No. 2001-26 as amended, the Zoning By-law for the Municipality of Magnetawan with respect to lands located on Part of Lot 25 and Parts 1 to 3, Concession 7, Plan 42R-18689 in the former geographic Township of Chapman, now in the Municipality of Magnetawan.

WHEREAS the Council of the Corporation of the Municipality of Magnetawan is empowered to pass By-laws to regulate the use of land pursuant to Section 34 of the Planning Act, R.S.O. 1990.

AND WHEREAS the owner of the subject lands has filed an application with the Municipality of Magnetawan to amend By-law No. 2001-26 as amended;

AND WHEREAS the Council of the Corporation of the Municipality of Magnetawan deems it advisable to amend By-Law 2001-26 as amended;

NOW THEREFORE the Council of the Corporation of the Municipality of Magnetawan hereby enacts as follows:

1. THAT Schedule 'A-2', to Zoning By-law No. 2001-26 as amended, is hereby further amended by zoning a portion of lands legally described as Part of Lot 25 and Parts 1 to 3, Concession 7, Plan 42R-18689 in the former geographic Township of Chapman, now in the Municipality of Magnetawan from Rural (RU) to Rural Residential (RR) as shown on Schedule 'A-2' attached hereto and forming part of this By-law.
2. In all other respects the provisions of By-law no. 2001-26, as amended, shall apply.

This By-law shall come into effect upon the date of passage hereof, subject to the provisions of Section 34 (30) and (31) of the Planning Act (Ontario).

ADOPTED SEPTEMBER 11, 2013.

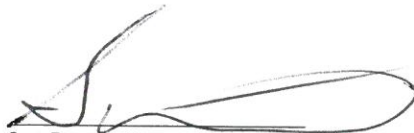
  
Sam Dunnett, Mayor

  
Roger Labelle, Clerk

**SCHEDULE 'A-2'**  
**Part of Lot 25 and Parts 1 to 3, Plan 42R-18689**  
**Concession 7**

Geographic Township of Chapman  
Municipality of Magnetawan

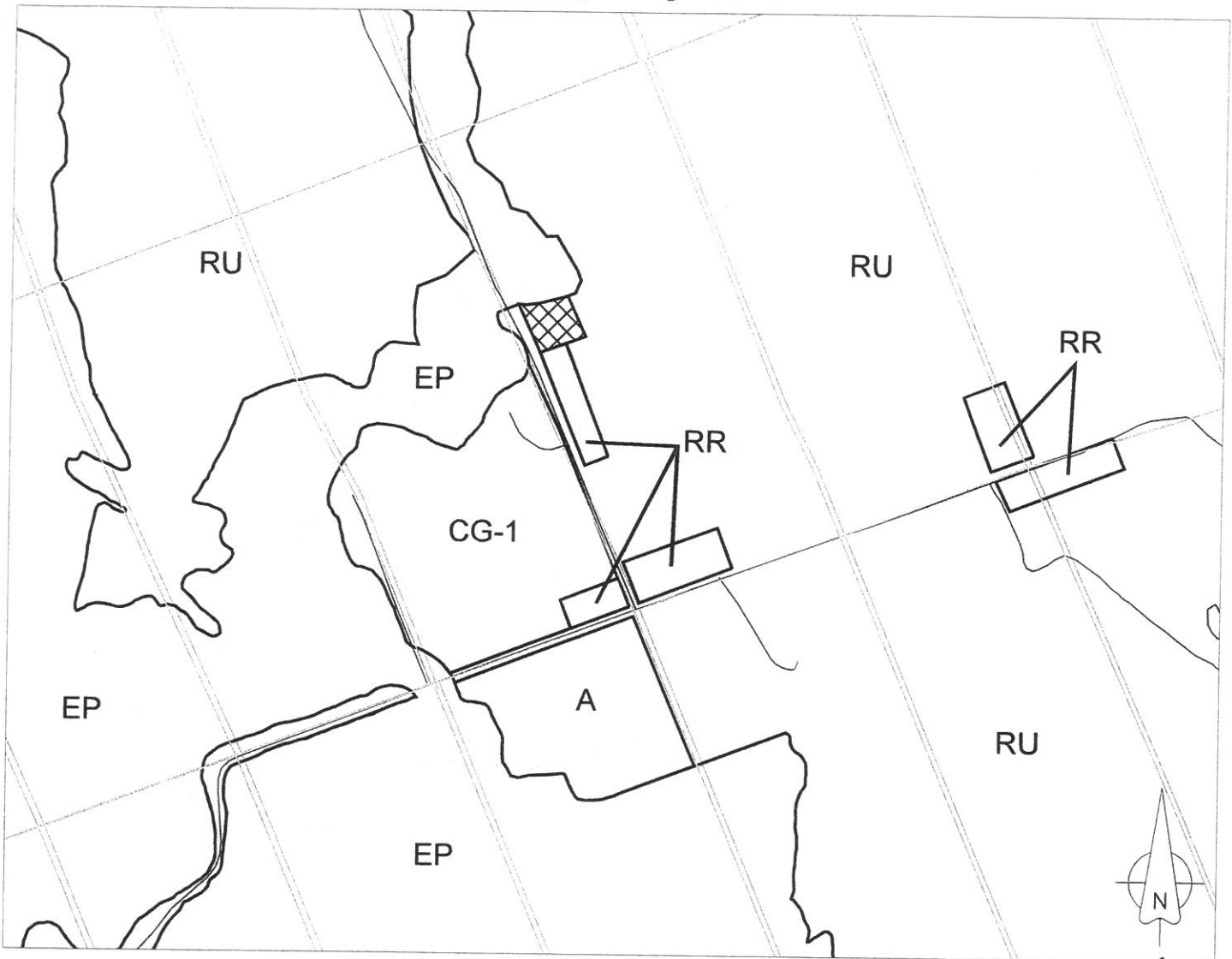

Lands to be rezoned from the Rural (RU) Zone to the Rural Residential (RR) Zone

THIS IS SCHEDULE 'A-2' TO ZONING BY-LAW 2013- 19  
PASSED THIS 11 DAY OF SEPT., 2013

  
MAYOR

  
CLERK